

ANACONDA ATEX FITTINGS

BXA ATEX FITTINGS IP66 / IP68



Anaconda IECEX-ATEX cable-hose-fitting, type BXA, nickel plated brass.

The IECEX-ATEX approved barrier fittings type BXA are developed to protect several loose wires with a liquidtight flexible metal conduit in potentially explosive atmospheres (ATEX). They fit directly on every type of Anaconda Sealtitle metal conduit. The barrier has to be made through a 2 component epoxy sealing which will be supplied together with the fittings. They are frequently used in the chemical and petrochemical Industry, Oil & Gas, off-shore and food industry. Typical applications are connections on big motors, transformers, control equipment and terminal boxes. In case a 45° or 90° solution is needed it is possible to use the IECEX-ATEX barrier Anaconda adapter type BXC in combination with a 45° or 90° fitting.



Material & Construction:

Construction: Nickel plated brass fitting, consisting of 5 parts (counter nut, clamping ring, ferrule, barrier container and body).

Separately a 2 component epoxy sealing will be supplied for creating the barrier.

Material: Counter nut, ferrule, barrier container and body are nickel plated brass, clamping ring is from PTFE.

Also available in stainless steel AISI-316.

Fittings are fully RoHS compliant.

Temperature: -60 °C till +80 °C continuous.

Protection class: IP 67 on the conduit and IP 66 between body and switchbox. IP 68 can be obtained with a flat seal between body and switchbox.

Colour: Metal.

For loose wires, IECEX-ATEX certified and marked;
 RCN (type) (threadsize) CE IECEX CESI 10.000X Ex d/e I, Mb, IIC Gb, Ex tb IIIC Db
 Ex0000CESI00ATEX0000X I M2 / II 2 GD IP66 IP68 EAC 

BXA, ISO, Explosionproof IECEX-ATEX cable-hose-fitting, nickel plated brass, barrier type (-60 °C till +80 °C).

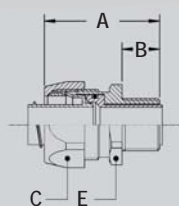

Thread	Sealtitle Size (inch)	Min. Internal Bore (mm)	Dimensions in mm						Standard Package	Article Number	Weight (Kg/100)
			A	B	C	E	F				
M16 x 1,5	3/8"	10,4	44	15	26	25	-	10	826.016.0	9,2	
M20 x 1,5	1/2"	13,8	46	15	30	28	-	10	826.020.0	11,9	
M25 x 1,5	3/4"	18,5	47	15	35	34	-	5	826.025.0	16,0	
M32 x 1,5	1"	23,8	48	15	45	43	-	5	826.032.0	26,4	
M40 x 1,5	1.1/4"	31,9	53	15	55	52	-	2	826.040.0	39,5	

BXA, NPT, Explosionproof IECEX-ATEX cable-hose-fitting, nickel plated brass, barrier type (-60 °C till +80 °C).

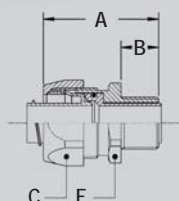

Thread	Sealtitle Size (inch)	Min. Internal Bore (mm)	Dimensions in mm						Standard Package	Article Number	Weight (Kg/100)
			A	B	C	E	F				
NPT 1/2"	3/8"	10,4	49	20	26	25	-	10	827.012.0	10,8	
NPT 1/2"	1/2"	13,8	51	20	30	28	-	10	827.016.0	13,1	
NPT 3/4"	3/4"	18,5	53	21	35	34	-	5	827.020.0	16,9	
NPT 1"	1"	23,8	58	25	45	43	-	5	827.026.0	29,8	
NPT 1.1/4"	1.1/4"	31,9	64	26	55	52	-	2	827.035.0	44,4	



Anaconda IECEX-ATEX cable-hose-fitting, type BX A ISI-316, stainless steel.

The IECEX-ATEX approved barrier fittings type BX A ISI-316 are developed to protect several loose wires with a flexible metal conduit in potentially explosive atmospheres (ATEX). They fit directly on every type of Anaconda Seallite conduit. The barrier has to be made through a 2 component epoxy sealing which will be supplied together with the fittings. The stainless steel AISI-316 material guarantees the best resistance against corrosion and chemical attacks. They are frequently used in the chemical and petrochemical Industry, Oil & Gas, off-shore and food industry. Typical applications are connections on big motors, transformers, control equipment and terminal boxes. In case a 45° or 90° solution is needed it is possible to use the IECEX-ATEX barrier Anaconda adapter type BXC AISI-316 in combination with a 45° or 90° Anaconda fitting.

Material & Construction:

Construction: Stainless steel AISI-316 fitting, consisting of 5 parts (counter nut, clamping ring, ferrule, barrier container and body).

Separately a 2 component epoxy sealing will be supplied for creating the barrier.

Material: Counter nut and body are stainless steel AISI-316, the barrier container and ferrule are nickel plated brass and the clamping ring is from PTFE.

Fittings are fully RoHS compliant.

Temperature: -60 °C till +80 °C continuous.

Protection class: IP67 on the conduit and IP66 between body and switchbox. IP 68 can be obtained with a flat seal between body and switchbox.

Colour: Metal.

For loose wires, IECEX-ATEX certified and marked;

▲ RCN (type) (threadsize) CE IECEX CESI 10.000X Ex d/e I, Mb, IIC Gb, Ex tb IIIC Db
Ex0000CESI00ATEX0000X I M2 / II 2 GD IP66 IP68 EAC ⚡

BX A ISI-316, ISO, IECEX-ATEX cable-hose-fitting, stainless steel AISI-316, barrier type (-60 °C till +80 °C).

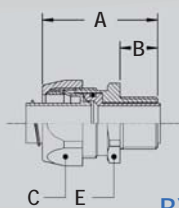

Thread ISO	Seallite Size (inch)	Min. Internal Bore (mm)	Dimensions in mm					Standard Package	Article Number	Weight (Kg/100)
			A	B	C	E	F			
M16 x 1,5	3/8"	10,4	44	15	26	25	-	10	826.016.9	8,7
M20 x 1,5	1/2"	13,8	46	15	30	28	-	10	826.020.9	11,2
M25 x 1,5	3/4"	18,5	47	15	35	34	-	5	826.025.9	15,1
M32 x 1,5	1"	23,8	48	15	45	43	-	5	826.032.9	24,9
M40 x 1,5	1.1/4"	31,9	53	15	55	52	-	2	826.040.9	37,3

BX A ISI-316, NPT, IECEX-ATEX cable-hose-fitting, stainless steel AISI-316, barrier type (-60 °C till +80 °C).

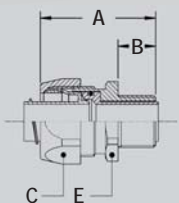

Thread NPT	Seallite Size (inch)	Min. Internal Bore (mm)	Dimensions in mm					Standard Package	Article Number	Weight (Kg/100)
			A	B	C	E	F			
NPT 1/2"	3/8"	10,4	49	20	26	25	-	10	827.012.9	10,2
NPT 1/2"	1/2"	13,8	51	20	30	28	-	10	827.016.9	12,4
NPT 3/4"	3/4"	18,5	53	21	35	34	-	5	827.020.9	16,0
NPT 1"	1"	23,8	58	25	45	43	-	5	827.026.9	28,1
NPT 1.1/4"	1.1/4"	31,9	64	26	55	52	-	2	827.035.9	41,9